



SERVICE PROCEDURE

Steps to Manually Reset Arbor in Retention Bracket

Applicable Model(s)

Jobsite Saw (JSS), Professional Cabinet Saw (PCS), Industrial Cabinet Saw (ICS/CB)

Tools Needed

- Blade wrenches
- Gloves or shop towel

Related Links

- [Resetting the arbor arm on JSS/PCS/ICS table saws](#)

PROCEDURE SUMMARY

This procedure demonstrates how to manually reset the arbor in the retention bracket on the JSS, ICS, CB, and PCS model saws. A manual reset might be required if the arbor does not lock in place, drops during operation, or can be moved freely while the saw is off. This most often occurs after your saw had a safety activation.

SAFETY

WARNING: Disconnect the plug from the power source from the tool before making any adjustments, changing accessories, or storing power tools. Such preventive safety measures reduce the risk of starting the power tool accidentally.

WARNING: When servicing your tool, use only replacement parts from SawStop.

WARNING: Keep handles and grasping surfaces dry, clean and free from oil and grease. Slippery handles and grasping surfaces do not allow for safe handling and control of the tool in unexpected situations.

WARNING: Read and understand the instruction manual and all safety warnings that came with your tool before attempting to maintain or operate the tool. Failure to follow instructions or heed warnings may result in electric shock, fire, serious personal injury or property damage. Save these instructions and refer to them whenever necessary.



SERVICE PROCEDURE

PERFORM STANDARD RESET PROCEDURE

Before performing a manual reset, attempt the standard reset procedure as described in the owner's manual.

1. Remove the table insert. (Image 1)

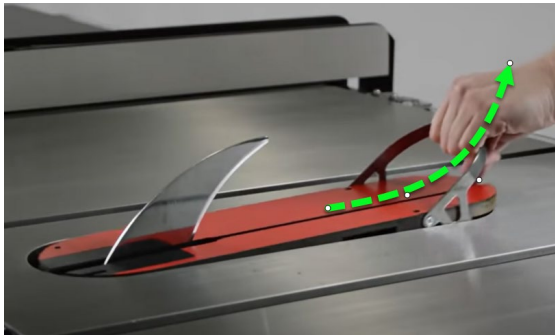

Image 1

2. Rotate the elevation handwheel counterclockwise, bringing the elevation mechanism to its lowest position. There will be some resistance but continue to lower the assembly until the lower limit is reached. The arbor should lock back in place at the bottom of travel with an audible sound. (Image 2)



Image 2

3. Rotate the elevation adjustment clockwise to raise the mechanism to the upper limit. (Image 3)

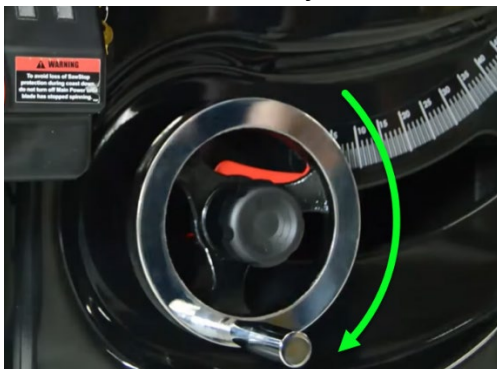

Image 3



SERVICE PROCEDURE

4. Place a towel over the blade and the arbor wrench over the arbor nut. Grasping the wrench and blade, push downward to make sure the arbor does not move freely. (Image 4)



Image 4

5. If the standard reset procedure was unsuccessful, it is likely compacted sawdust and debris is blocking necessary full travel of the elevation mechanism and a thorough cleaning is recommended before proceeding. If the saw must be returned to service before performing the suggested cleaning, resetting the arbor arm manually is detailed below.

PERFORM MANUAL RESET PROCEDURE

1. Rotate the elevation adjustment to its upper limit. The blade may not raise fully. When the handwheel will not rotate further, do not attempt to force it to continue. (Image 5)

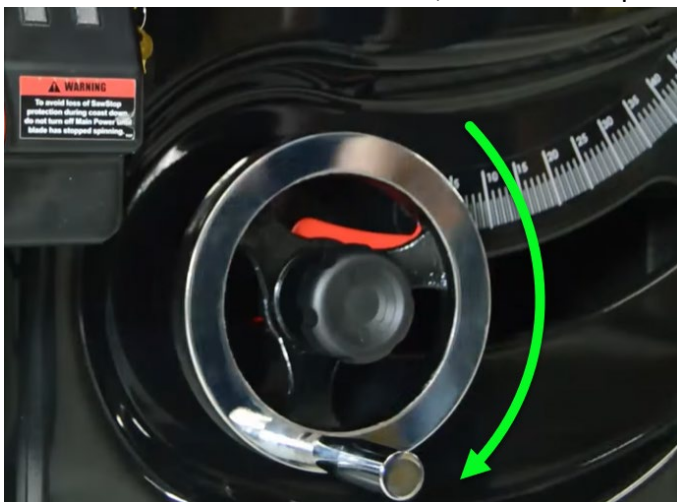

Image 5



SERVICE PROCEDURE

2. Remove the table insert. (Image 6)

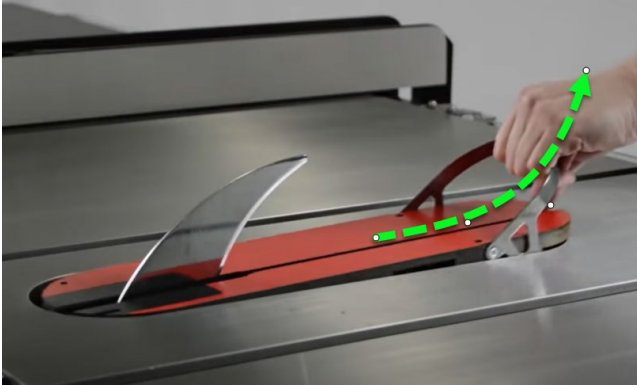

Image 6

3. Place the closed end of a blade wrench around the arbor nut. Push downward to make sure the arbor is down as far as it will go. (Image 7)



Image 7

4. With the closed end of a blade wrench still around the arbor nut, pull firmly and sharply upward. The arbor should lock back into place with an audible sound. (Image 8)

WARNING: When pulling upward, be careful not to hit yourself with the blade wrench.

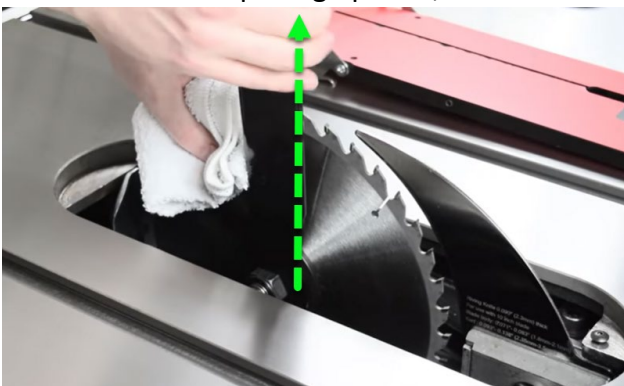

Image 8



SERVICE PROCEDURE

5. Ensure the arbor is locked by placing the closed end of a blade wrench around the arbor nut. Grasping the wrench and blade, push downward making sure the arbor does not move freely. (Image 9)

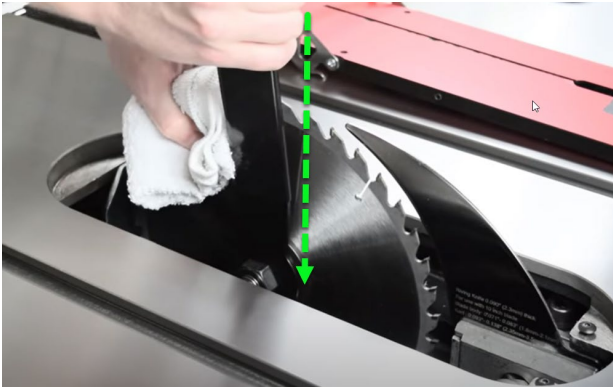

Image 9